

the. **Speak-er**

Contents

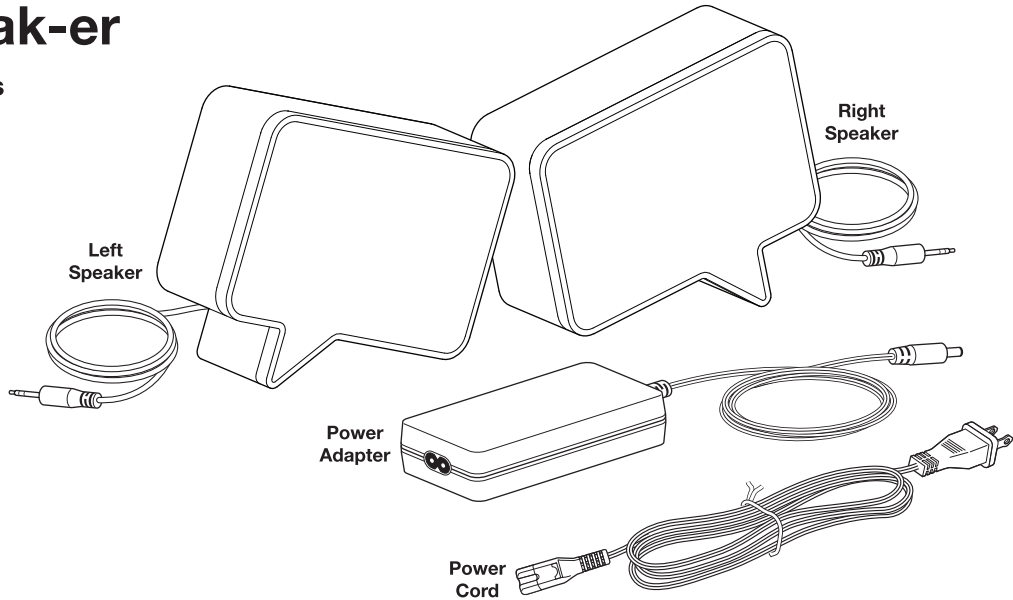

Customer Service

Many thanks for your purchase! We hope you'll be as happy with the *Speak-er* as we were in designing and producing it.

We've taken every step possible to ensure top-notch quality. If you have any questions that are not answered by the following instructions, or find something missing or wrong with your speakers, please send us an email at speaker@thinkofthe.com. We'll respond to you as soon as we can.

Thanks again and enjoy!

Technical Specifications

Speakers	2" full range
Power	6 Watts per speaker
Dimensions	H 4" x W 6" x L 2"
Weight	2 kg per speaker
Input Impedance	>5k Ohm
Signal to Noise Ratio	>70dB
Frequency Response	60 – 20kHz
Input Sensitivity	400 mV for rated power
Maximum Power Consumption	20 watts

Safety Instructions

- Read, keep, and follow these instructions.
- Do not use this apparatus near water. This apparatus shall not be exposed to dripping or splashing, and no objects filled with liquids, such as vases, shall be placed on the apparatus.
- Clean with a dry cloth. If necessary, use a damp cloth without any solvents.
- Do not expose the speaker system to temperature or humidity extremes, direct sunlight, excessive dust, or vibrations.
- Place the speaker system on a stable, level surface. Do not drop, apply excessive force to the controls, or put heavy objects on top.
- Do not block any ventilation openings.
- Do not install near any heat sources such as radiators, heat registers, stoves, or other apparatus (including amplifiers) that produce heat. No naked flame sources, such as lighted candles, should be placed on the apparatus.
- In order to protect the speaker system, avoid microphone feedback, continuous output from electronic musical instruments, or distorted output from any signal source.
- Do not place the speakers close to fluorescent or neon light sources.
- Although the speakers are magnetically shielded, keep magnetic storage media (disks and tapes) at least four inches from the speaker system in order to avoid data loss.
- Do not defeat the safety purpose of the polarized or grounding-type plug. A polarized plug has two blades with one wider than the other. A grounding type plug has two blades and a third grounding prong. The wide blade or the third prong are provided for your safety. If the provided plug does not fit into your outlet, consult an electrician for the replacement of the obsolete outlet.
- Protect the power cord from being walked on or pinched – particularly at plugs, convenience receptacles, and the point where they exit from the apparatus.
- Do not install in an area which impedes the access to the power plug. Disconnecting the power plug is the only way to completely remove power to the product and must be readily accessible at all times.
- Power source – use only power supplies of the type specified in the operating instructions or as marked on the appliance. If a separate power supply is included with this apparatus, do not substitute with any other power supply – use only manufacturer-provided power supplies.
- Unplug this apparatus during lightning storms or when unused for long periods of time.
- Refer all servicing to qualified service personnel. Servicing is required when the apparatus has been damaged in any way, such as power-supply cord or plug is damaged, liquid has been spilled or objects have

fallen into the apparatus, the apparatus has been exposed to rain or moisture, does not operate normally, or has been dropped.

- To reduce the risk of electrocution, do not attempt to open the speakers. There are no user serviceable parts inside.
- When a cart is used, use caution when moving the cart/apparatus combination to avoid injury from tip-over.
- This product shall not be treated as household waste. Instead it shall be handed over to the applicable collection point for the recycling of electrical and electronic equipment. By ensuring this product is disposed of correctly, you will help prevent potential negative consequences for the environment and human health, which could otherwise be caused by inappropriate waste handling of this product. The recycling of materials will help to conserve natural resources. For more detailed information about recycling of this product, please contact your local city office or your household waste disposal service.

FCC Statement and Warning

This equipment has been tested and found to comply with the limits for a Class B digital device, pursuant to Part 15 of the FCC rules. These limits are designed to provide reasonable protection against harmful interference in a residential installation. This equipment generates, uses and can radiate radio frequency energy and, if not installed and used in accordance with the instructions, may cause harmful interference to radio communications. However, there is no guarantee that interference will not occur in a particular installation. If this equipment does cause harmful interference to radio or television reception, which can be determined by turning the equipment on and off, the user is encouraged to try to correct the interference by one or more of the following measures:

- a) Re-orient or relocate the receiving antenna.
- b) Increase the separation between the equipment.
- c) Connect the equipment to an outlet on a circuit different from that to which the receiver is connected.
- d) Consult the dealer or an experienced radio/TV technician for help.

MODIFICATIONS NOT EXPRESSLY APPROVED BY THE MANUFACTURER COULD VOID THE USER AUTHORITY TO OPERATE THE EQUIPMENT UNDER FCC RULES.

Set Up Instructions

Step 1

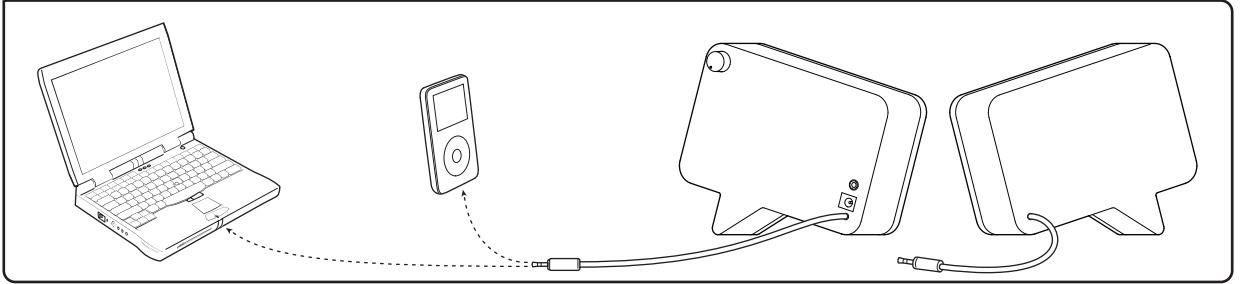

Step 2

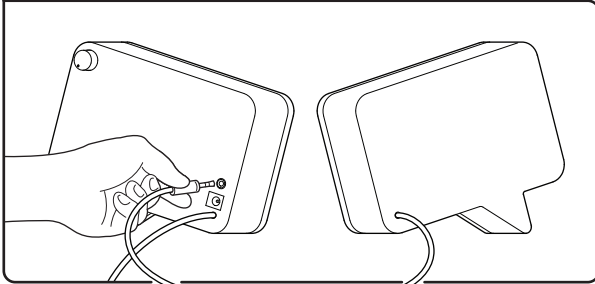

Step 3

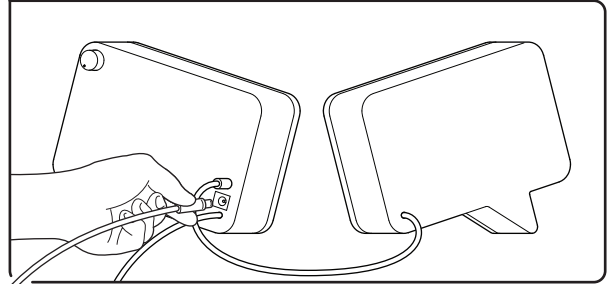

Step 4

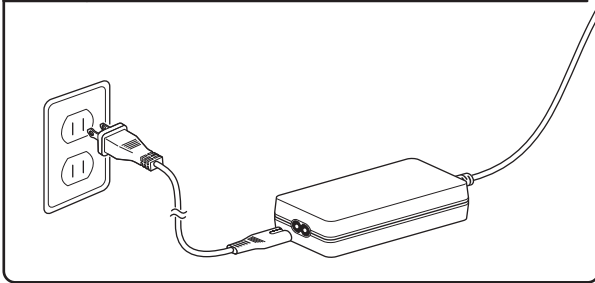

Step 5

